

KIT F40th

Technical Sheet

Beryllium Tweeters



SPECIFICATIONS

| | | |
|----------------------|-------------------------|---|
| Nominal power | 15W (without filtering) | |
| Maximum power | 200W (with filtering) | |
| Sensitivity(2.83V/m) | 94.1dB | |
| Cone | Beryllium | |
| Surround | Foam | |
| Nom. impedance | 8Ω | |
| DC resistance | 6Ω | |
| VC diameter | 20mm | $\text{O}^{25/32''}$ |
| Former | Aluminum | |
| Layers | 2 | |
| Wire | Aluminum | |
| Inductance | 0.06mH | $3^{11/32''} \times \text{O}^{25/32''}$ |
| Xmax | - | 2976.2lbs |
| Magnet | Neodymium | |
| Flux density | 2.1 T | |
| Gap height | 2.5mm | $\text{O}^{3/32''}$ |
| Net weight | 0.2kg | 0.44lb |

FREQUENCY RESPONSE/IMPEDANCE

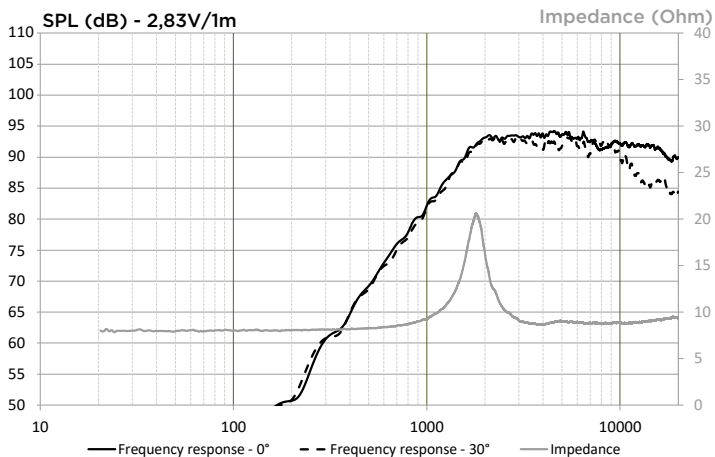

PARAMETERS

| | |
|-----|--------------------|
| Fs | 1294Hz |
| Vas | - |
| Qts | - |
| Qes | - |
| Qms | - |
| Re | 6Ω |
| Sd | 4.9cm ² |
| Cas | - |
| Mas | - |
| Ras | - |
| Cms | - |
| Mms | - |
| Rms | - |
| Ces | - |
| Les | - |
| Res | 42Ω |
| Bl | - |
| SPL | 93dB/W/m |

MECHANICAL DRAWING

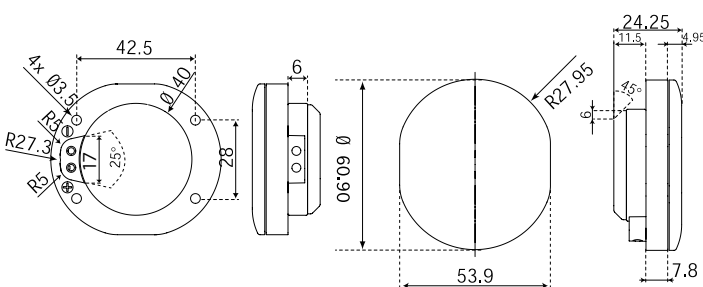

KIT F40th

Technical Sheet

Woofers 6½"



SPECIFICATIONS

| | |
|----------------|--|
| Nominal power | 80W |
| Maximum power | 160W |
| Sensitivity | 92.8dB |
| Nom. impedance | 2Ω |
| Cone | Flax |
| Surround | Butyl |
| DC resistance | 1.8Ω |
| VC diameter | 32mm 3 ¹ / ₈ " |
| Former | Kapton |
| Layers | 2 |
| Wire | Copper |
| Magnet (D x H) | 85x20mm 3 ¹ / ₃₂ " x 0 ²⁵ / ₃₂ " |
| Net weight | 1.35kg 3lbs |

FREQUENCY RESPONSE/IMPEDANCE

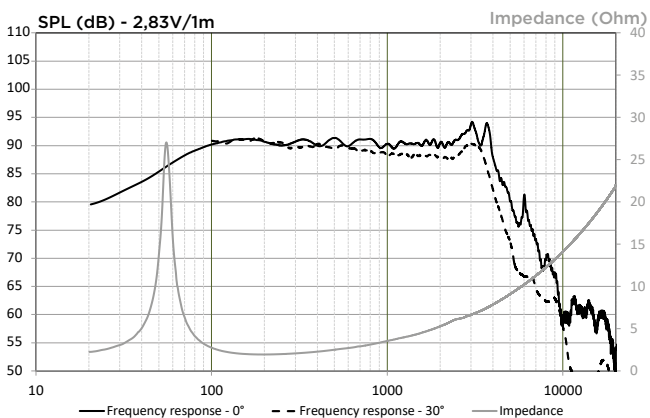

PARAMETERS

| | |
|------|-----------------------|
| Rdc | 1.8Ω |
| Fs | 55Hz |
| Mms | 20.2g |
| Cms | 0.415mm/N |
| Vas | 10.4L |
| Qts | 0.53 |
| Qes | 0.56 |
| Qms | 9.1 |
| Bxl | 4.66 N/A |
| Sd | 132.73cm ² |
| SPL | 87dB |
| Xmax | 4.5mm |

MECHANICAL DRAWING

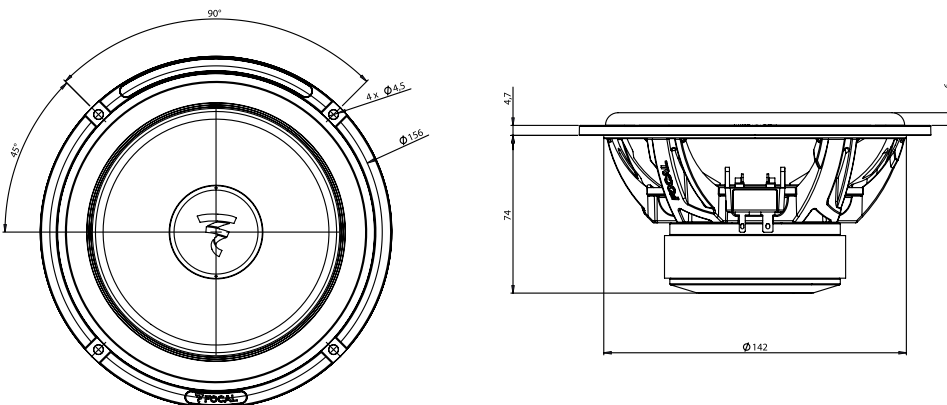

KIT F40th

Technical Sheet

Subwoofer 10"



SPECIFICATIONS

| | |
|----------------------------|--|
| Nominal power | 600W |
| Maximum power | 1200W |
| Sensitivity | 87.5dB |
| Nom. impedance | 4+4Ω |
| Cone | Flax |
| Surround | Butyl |
| DC resistance | 3.2+3.2Ω |
| VC diameter | 65mm 2⁹/₁₆" |
| Former | Glass fiber |
| Layers | 4 |
| Wire | CCAW |
| Net weight | 10.6kg 23.4lbs |
| Driver displacement | 3L |

FREQUENCY RESPONSE/IMPEDANCE

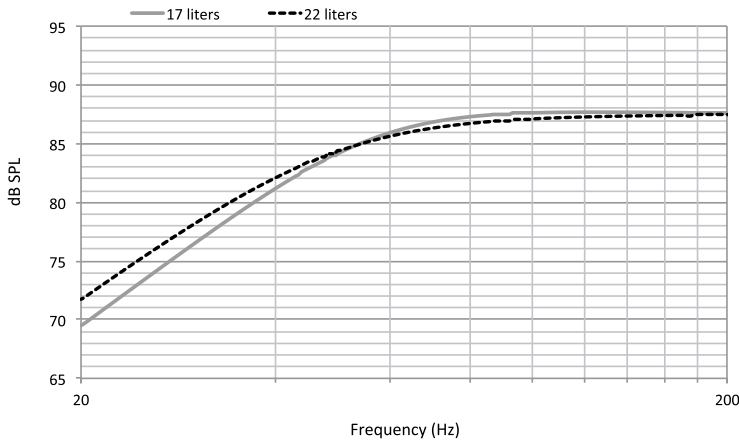

PARAMETERS

| | |
|-------------|--------------------|
| Rdc | 3.2+3.2Ω |
| Fs | 40Hz |
| Mms | 168g |
| Cms | 0.08mm/N |
| Vas | 12 l |
| Qts | 0.55 |
| Qes | 0.614 |
| Qms | 5 |
| Bxl | 22.12 N/A |
| Sd | 327cm ² |
| SPL | 84.5dB |
| Xmax | 22.5mm |

MECHANICAL DRAWING

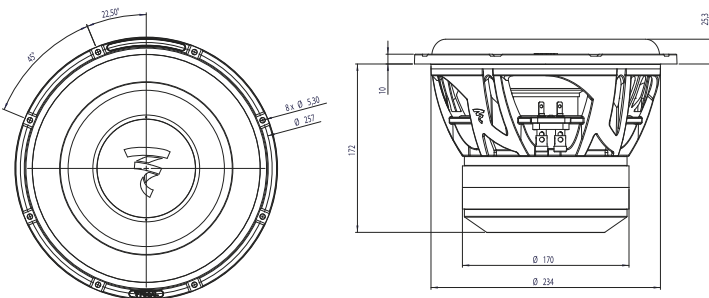

SUGGESTED APPLICATIONS

Sealed enclosure

| Volume | F-3 (Hz) |
|---------------------------|----------|
| 17L 0.65 cu.ft. | 51Hz |
| 22L 0.78 cu.ft. | 48Hz |

Ported enclosure

| Volume | F-3 (Hz) | Ø event Ø port | LG event Port length |
|---------------------------|----------|---|--|
| 22L 0.78 cu.ft. | 33Hz | 8cm 3 ⁵ / ₃₂ " | 35cm 13 ²⁵ / ₃₂ " |
| 30L 1 cu.ft. | 27Hz | 8cm 3 ⁵ / ₃₂ " | 43cm 16 ¹⁵ / ₁₆ " |

KIT F40th

Technical Sheet

FSP-8 : 8-channel sound processor



- High-resolution digital compatibility via optical input (24 bits/192kHz)
- FSP-8 DSP MANAGER:
User-friendly interface for maximum efficiency when sculpting "Your" Focal Sound
- Recall of stored presets and main settings management through the remote control (sold separately).
- Selectable high/low-level inputs for compatibility with factory or after-market head units
- Remote control with LED screen (sold separately)
- Software compatibility:
Windows XP/Vista/Seven/8/10

MECHANICAL DRAWING

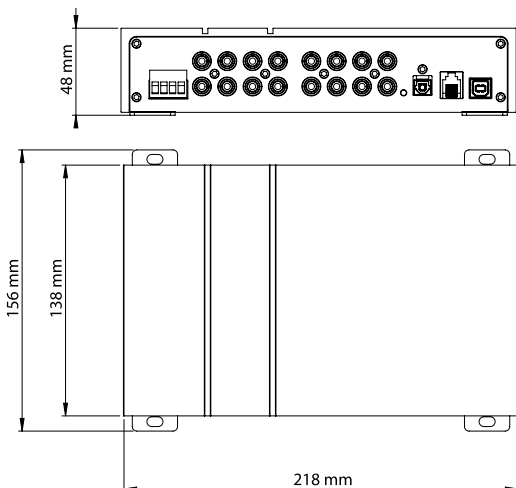

FSP-8 DSP MANAGER:

Compatibilité logiciels :
Windows XP / Vista / 7 / 8 / 10

Télécharger pour Windows

SPECIFICATIONS

INPUTS

| | |
|---|----------------------|
| Low-level input sensitivity (Analog and Aux) | 1.2V - 4.9V |
| High-level input sensitivity (Analog and Aux) | 4.8V - 20.6V |
| Digital input formats supported (optical) | up to 24 bits/192kHz |

OUTPUTS

| | |
|---|--|
| Number of channels | 8 |
| Max. output (with 10kΩ level) | 3.4V |
| Frequency response (digital crossover off/-3dB) | 5Hz - 21kHz |
| Signal/noise ratio | -90dBA (analogue input) -99dBA (optical) |
| Harmonic distortion - 10kΩ - @1kHz (with 22kHz low-pass filter) | 0.02% |
| Crosstalk - 4Ω - @1kHz | -78dB |
| Gain adjustment range | 64dB |
| Equaliser | 10 bands, each fully customisable for each channel |
| Adjustable high-pass crossover | 16Hz - 20kHz |
| Adjustable low-pass crossover | 16Hz - 20kHz |
| Adjustable bandpass crossover | 16Hz - 20kHz |
| Latency adjustment range | 0-22ms per channel |
| Latency adjustment steps | 0.1ms |
| Phase inverter | ✓ |

General

| | |
|--|--|
| Easy Configuration | ✓ |
| Dynamic help | ✓ |
| Power consumption on standby (product on, no signal, 14.4 Vin) | 0.7A (0.73 A with remote) |
| Power consumption OFF (14.4 Vin, remote OFF) | < 50μA |
| Remote control | Sold separately |
| Protection | Polarity inverter |
| Weight | 3lbs (1.35kg) |
| Dimensions (LxWxH) | 8 ⁹ / ₁₆ "x5 ⁷ / ₁₆ "x1 ⁷ / ₈ " (21.8cmx13.8cmx4.8cm) |

KIT F40th

Technical Sheet

FPX 5.1200: D Class Premium amplifier



- D Class amplifier - 5 output channels
- Copy mode: 6/4/2 inputs
- Stable under 2Ω
- High power and current dynamic reserve (1 200W max.)
- Audio Mos-Fets - optimized efficiency
- Subwoofer remote control supplied

MECHANICAL DRAWING

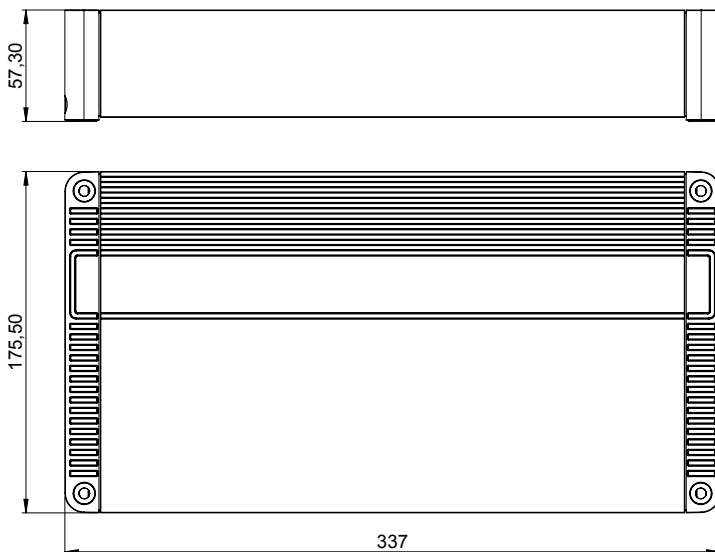

SPECIFICATIONS

AUDIO SPECIFICATIONS

CEA power (4 ohms) 4x75Wrms + 1x420Wrms

Max. power (2 ohms) 4x120Wrms + 1x720Wrms

Power max (channels 1 to 4 bridged at 4 ohms + channel 5 at 2 ohms) 2x240Wrms + 1x720Wrms

Bandwidth (-3dB) 10Hz - 20kHz

THD 0.03%

SNR (1W/A) > 75dB

GENERAL FEATURES

Subsonic filter 10Hz-50Hz (24dB/oct)

High-pass/low-pass filter 50Hz - 500Hz

Bass boost 0 to 12dB linear

Phase 0 to 180° linear

Full-range function ✓

Mirror mode ✓

Standby current (A) 1,7

Protections Short circuit/low impedance/reverse polarity/DC/voltage drop/overheat protection

Dimensions (LxWxH) 13^{17/64}"x6^{57/64}"x2^{1/4}" (337x175x57mm)

Weight (kg) 9lbs (4.1kg)

Operating voltage range 8.3 to 16V